



# KANSAS AGRIBUSINESS EXPO

LARGEST AGRIBUSINESS EXPO IN MIDWEST



*"Staying the Course in 2012"*

**NOVEMBER 16-17, 2011**  
**OVERLAND PARK CONVENTION CENTER**

A jointly-sponsored trade show of the  
Kansas Grain and Feed Association and the Kansas Agribusiness Retailers Association

# HOTELS

The following hotels have room blocks reserved for KABE attendees. Please contact the hotels directly for reservations.

## Sheraton Hotel

6100 College Blvd.  
(913) 234-2100  
\$151.00\* until 10/24

## Hilton Garden Inn

5800 College Blvd.  
(913) 345-2661  
\$119.00\* until 10/15

## Courtyard Marriott

11001 Woodson St.  
(913) 317-8500  
\$99.00 until 10/14

## Doubletree Hotel

10100 College Blvd.  
(913) 323-1905  
\$99.00\* until 10/16

## Holiday Inn & Suites

10920 Nall Ave.  
(913) 312-5991  
\$94.00\* until 10/21

## Chase Suites Hotel

6300 W. 110th St.  
(913) 491-3333  
\$89.00\* until 10/14

## Drury Inn & Suites

10963 Metcalf Ave.  
(913) 345-1500  
\$84.99\* until 10/14

## Pear Tree Inn

10951 Metcalf Ave.  
(913) 451-0200  
\$64.99\* until 10/14

\*includes free wireless internet

# SET UP, TEAR DOWN

Please read all information in this section thoroughly. New rules and regulations apply this year in Overland Park.

## Large Equipment Parking:

If you need to park large equipment prior to Monday, November 14, you can do so on the grassy area surrounding the north parking lot of the Convention Center. Please do not use actual parking spaces.

## Large Equipment Move-In and Move-Out:

Large Equipment may move in Monday, November 14, from 10am to 6pm or Tuesday, November 15 from 8-10am. All equipment must be in place by that time. No overhead doors will be open beyond 10am. Large equipment and vehicles are easier to move-in prior to pipe and drape set-up, which takes place after 10am on Tuesday. The overhead doors will not be opened Thursday afternoon or evening. Large equipment may begin moving out Friday morning, November 18 at 7 am. However, please remember that Kansas City has limitations on transporting oversize equipment during rush hour traffic.

## Installation of 10x10 Exhibits:

Installation of 10x10 exhibits may occur on Tuesday, November 15 from 8am-5pm. All exhibits must be fully installed by 5pm on Tuesday, November 15. A staff member or decorating company representative will be available during move-in to assist you with any booth questions.

\*\*Only 10x10 exhibits will be allowed to move-out Thursday, November 17, after the trade show closes at 4pm. The big overhead doors will not be opened for anyone Thursday afternoon and evening, so 10x10 exhibits will need to use side doors. 10x10 exhibits can also move out on Friday morning, November 18 beginning at 7am.

## Miscellaneous Information for all Exhibitors:

A forklift will be available Monday, November 14 for move-in & Friday, November 18 for move-out. Forklift fees will be paid by the exhibitor. Charges incurred in 15-minute increments. Power washers are available outside the overhead entrance doors on Monday, November 14 (ONLY) for large equipment. If large equipment plans to move-in on Tuesday, November 15 you will be responsible to wash your own equipment. Power washers are provided courtesy of KGFA & KARA.

Forms to order forklift service, additional furniture, carpet, electrical service, etc., as well as information on shipping will be mailed in August or available at [www.georgefern.com](http://www.georgefern.com) after July 2.

# SCHEDULE

## Monday, November 14

10am – 6pm Large Equipment Move-In

## Tuesday, November 15

8am – 10am Large Equipment Move-in (continues)  
8am – 5pm 10x10 Exhibit Move-in  
10am Sporting Clay Shoot - Powder Creek Shooting Park  
10am Golf Tournament – Deer Creek Golf Club  
10am All Large Equipment must be in place  
5pm – 6pm Exhibitor Appreciation Reception  
2012 Free Booth Drawing - must be present to win

## Wednesday, November 16

9am Ribbon Cutting, Trade Show Opening  
9am – 6pm Trade Show Floor Open  
3pm – 6pm Reception on Trade Show Floor  
4:30pm – 6pm Scholarship Auction on Trade Show Floor  
6pm – 8pm Chairmen's Reception at Convention Center

## Thursday, November 17

7:30am Breakfast, Keynote Speaker & TAL Graduation at Sheraton Hotel  
9am Trade Show Opens  
3pm – 4pm Reception on the Trade Show Floor  
4pm – 10pm 10x10 Exhibit Move-out  
5pm – 5:45pm Reception at Sheraton  
6:30pm Dinner and Show at New Theatre  
*Game Show* starring Seinfeld's John O'Hurley

## Friday, November 18

7am – 12noon Large Equipment Move-out  
10x10 Move-out Continues

# CONTACT

For additional information, please visit [www.ksabe.org](http://www.ksabe.org) or contact:

Shari Bennett, Expo Manager  
(785) 234-0464, [shari@kansasag.org](mailto:shari@kansasag.org)

# BOOTH FEES & FLOOR LAYOUT

Booth rental fees are listed below. A 50% deposit is due when the contract is signed. All booth fees must be paid in full by October 1, 2011.

Booth Size	Cost for Member*	Cost for Non-Member
10x10 Booth	\$580.00	\$855.00
20x20 Booth	\$1,220.00	\$1,495.00
20x30 Booth	\$1,615.00	\$1,890.00

Booths are furnished with an 8-foot or 6-foot draped table, two chairs, a wastebasket and a sign with the exhibitor's name. An Exhibitor Services Packet will be mailed in August. You can also download it at [www.georgefern.com](http://www.georgefern.com) after July 2. You will be able to choose your table and order additional items including electrical and phone line. **Exhibitors get two free registrations for every \$500 of booth space purchased**, which will include tickets to all functions except the Thursday evening dinner and entertainment. Please use the Exhibitor Contract to pre-register.

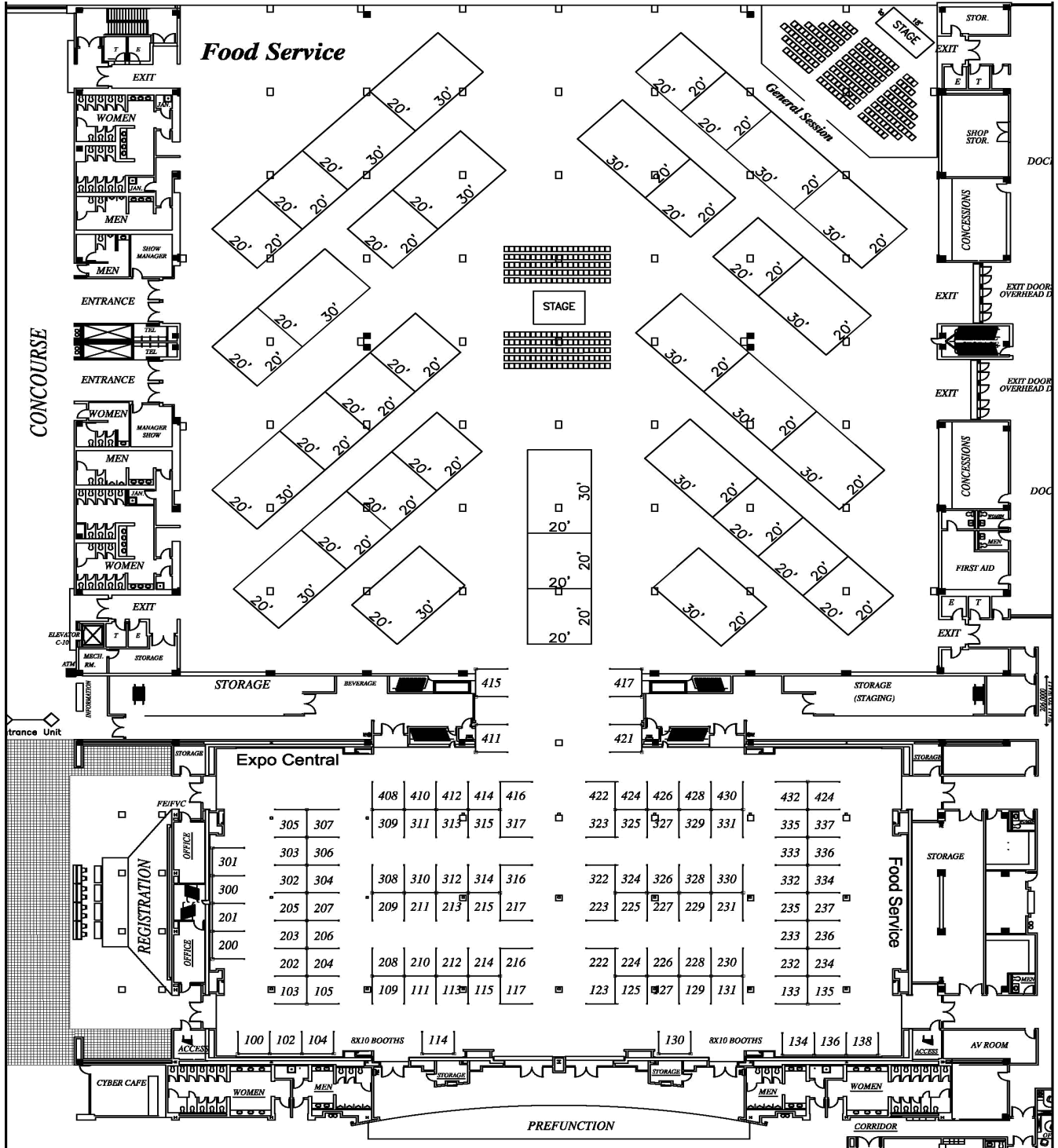

# EXHIBITORS AT 2010 SHOW

Adams Fertilizer Equipment	El Dorado Chemical Company	NA-CHURS/ALPINE Solutions
ADM Wholesale Fertilizer	EMD Crop BioScience	National Billing
Advanced Biological Marketing	Fairbank Equipment	Neville Welding Inc.
AFLAC	Farm Chem Corporation	New Century Ag Recruiters
Ag 1 Source, LLC	Frisbie Construction Co., Inc.	Pepper Maintenance Systems, Inc.
Ag Ads	Gamet Mfg. Inc.	Precision Grain Management Consultants
Ag Leader Technology	Grain Belt Supply Co. Inc.	RBH Mill & Elevator
Agrium U.S. Inc.	H & H Restoration	Reif Welding and Construction LLC
Agrotain International, LLC	HABCO, Inc.	Riggins R-Co. LLC
AgTrax Technologies	Hammel Scale Co., Inc.	Rolfes@Boone
AgVision Agribusiness Software	Harrington Health	Rosen's Inc.
Agworks, Inc.	Heartland Ag Inc.	Schaben Industries
All State Tower Company	Helena Chemical Co.	Seedburo Equipment Co.
Allied Environmental Consultants Inc.	ICEC	Show-Me Shortline
American Vanguard Corporation (AMVAC)	Intersystems	Simpson Farm Enterprises, Inc.
ASMARK INSTITUTE	Jeffersonville River Terminal	Sioux Rubber & Urethane
BarnesCo Inc.	John Deere	Software Solutions Integrated LLC
Barton Community College	Kansas City Board of Trade	Specialty Fertilizer Products
BASF Corporation	Kansas Corn Commission	Stine Seed Company
Bayer CropScience	Kansas Forage Products, LLC	Stueve Construction Company
Becker Underwood, Inc.	Kansas Grain Inspection Service Inc.	Summit Software, an iRely Company
Ben Trei Fertilizer Co., LLC	Kansas Highway Patrol	Syngenta Crop Protection
Brothers Equipment, Inc.	Kansas Soybean Commission	Tapco, Inc.
CBIZ MHM, LLC	Kansas Wheat	Terracon Consultants, Inc.
Cen-OK Services LLC	KC Supply Co. Inc.	Tetra Micronutrients, Inc.
Central States Hydroseal	Ken Babcock Sales, Inc.	The Essmueller Company
Charm Sciences	KFSA	The KBH Corporation
Chief Agri/Industrial	Korol Financial Group LLC	TMHC Services
CHS Crop Nutrients	KSU - Department of Agronomy	Tramco Inc.
Circle K Manufacturing	KSU - Grain Science & Industry Department	Tucker Testing Service
Convey-All by Hamilton Systems	Lang Diesel, Inc.	Union Iron, Inc.
CP Products Company, Inc.	Legacy Building Solutions	United Sorghum Checkoff Program
CPS Wholesale	Liberty Buildings, LLC	United Suppliers, Inc.
CrustBuster/Speed King Inc.	Manhattan Data Systems Inc.	Valleywide Sales, Inc.
C-Tec, Inc.	Marcus Construction Company	Van Diest Supply Company
DeBruce Fertilizer	McPherson Concrete Storage Systems	Vertical Software Inc.
Don's Tire	MFA Incorporated	Waconia Mfg., Inc.
Dow AgroSciences	MFS-York-Stormor	Ward Laboratories Inc.
Doyle Equipment Mfg. Co.	Mid-State Tank Co., Inc.	Westheffer Co. Inc.
Drake, Inc.	Mid-West Fertilizer Inc.	Winfield Solutions
Dultmeier Sales	Midwest Laboratories Inc.	Woofter Construction Irrigation, Inc.
DuPont Crop Protection	MK Minerals, Inc.	Wylie Sprayers
Edutech Systems Inc.	Monsanto	